

BUZZERS, RELAYS & TIMERS

BUZZERS, RELAYS & TIMERS LOCATION

Component	Component Location
AUX Relay	At right rear of vehicle. See <b>Fig. 2</b> .
Cooling Fan Relay (1)	In engine compartment fuse/relay box. See <b>Fig. 1</b> .
Cooling Fan Relay (3)	In engine compartment fuse/relay box. See <b>Fig. 1</b> .
Cooling Fan Relay (4)	In engine compartment fuse/relay box. See <b>Fig. 1</b> .
EBD & Warning Relay	At left rear side of engine compartment. See <b>Fig. 3</b> .
Front Blower Relay	In engine compartment fuse/relay box. See <b>Fig. 1</b> .
Front Defroster Relay	In junction block. See <b>Fig. 5</b> .
Front Foglight Relay	In engine compartment fuse/relay box. See <b>Fig. 1</b> .
Fuel Pump Relay	In engine compartment fuse/relay box. See <b>Fig. 1</b> .
Headlight Relay (High)	In engine compartment fuse/relay box. See <b>Fig. 1</b> .
Headlight Relay (Low)	In engine compartment fuse/relay box. See <b>Fig. 1</b> .
Horn Relay	In engine compartment fuse/relay box. See <b>Fig. 1</b> .
Main Relay	In engine compartment fuse/relay box. See <b>Fig. 1</b> .
Power Window Relay	In engine compartment fuse/relay box. See <b>Fig. 1</b> .
Rain Sensor High Relay	In junction block. See <b>Fig. 5</b> .
Rain Sensor Low Relay	In junction block. See <b>Fig. 5</b> .
Rear Blower Relay	At right rear side of vehicle. See <b>Fig. 2</b> .
Rear Defroster Relay	In engine compartment fuse/relay box. See <b>Fig. 1</b> .
Start Relay	In engine compartment fuse/relay box. See <b>Fig. 1</b> .
TNS Relay	In engine compartment fuse/relay box. See <b>Fig. 1</b> .

CIRCUIT PROTECTION DEVICES

CIRCUIT PROTECTION DEVICES LOCATION

Component	Component Location
Engine Compartment Fuse/Relay Box	At left side of engine compartment. See <b>Fig. 3</b> .
Junction Block	Behind left side of dash.

CONTROL UNITS

CONTROL UNITS LOCATION

Component	Component Location
ABS Control Unit	At left rear of engine compartment. See <b>Fig. 3</b> .

Air Bag Control Unit	At lower center of dash, on floor tunnel. See <b>Fig. 5</b> .
Auto Light Control Unit	Behind center of dash. See <b>Fig. 4</b> .
Cruise Control Unit	At right rear side of engine compartment. See <b>Fig. 3</b> .
DRL Unit	Below center of dash. See <b>Fig. 4</b> .
ETWIS	Below center of dash. See <b>Fig. 4</b> .
Flasher Unit	Below center of dash. See <b>Fig. 4</b> .
Keyless Entry Receiver	Behind lower right side of dash. See <b>Fig. 4</b> .
Powertrain Control Module	Below center of dash. See <b>Fig. 5</b> .
Sun Roof Control Unit	At front center of roof, in sun roof unit.

## MOTORS

### MOTORS LOCATION

Component	Component Location
Blower Motor	Behind right side of dash, on blower unit. See <b>Fig. 5</b> .
Condenser Fan Motor	Behind right side of radiator.
Cooling Fan Motor	Behind left side of radiator.
Front Washer Motor	At right front of engine compartment. See <b>Fig. 3</b> .
Front Wiper Motor	On right side of firewall. See <b>Fig. 3</b> .
Fuel Tank	On top of fuel tank.
Intake Actuator (Front)	Behind right side of dash, on blower unit. See <b>Fig. 5</b> .
Intake Actuator (Rear)	At right rear of vehicle, on rear blower unit. See <b>Fig. 2</b> .
Mix Actuator	Behind center of dash, on bottom of HVAC unit. See <b>Fig. 5</b> .
Mode Actuator	Behind center of dash, on bottom of HVAC unit. See <b>Fig. 5</b> .
Rear Blower Motor	At right rear of vehicle, on blower unit. See <b>Fig. 2</b> .
Rear Washer Motor	At rear of vehicle.
Rear Wiper Motor	At lower center of hatch. See <b>Fig. 2</b> .
Sun Roof Motor	At front center of roof, in sun roof unit.
Variable Intake Control Motor 1	At right front of engine. See <b>Fig. 6</b> .
Variable Intake Control Motor 2	At right front of engine. See <b>Fig. 6</b> .

## SENDING UNITS & SENSORS

### SENDING UNITS & SENSORS LOCATION

Component	Component Location
Air Flow Meter	At top rear of engine. See <b>Fig. 6</b> .
AMB Sensor	In front of condenser fan shroud. See <b>Fig. 3</b> .
Brake Fluid Level Sensor	On brake master cylinder reservoir assembly. See <b>Fig. 3</b> .
Camshaft Position Sensor	At front of engine. See <b>Fig. 6</b> .
Crankshaft Position Sensor	At front of engine, next to crankshaft sprocket. See <b>Fig. 6</b> .
Engine Coolant Temperature Sensor	At rear of engine. See <b>Fig. 6</b> .

Fuel Temperature Sensor	Near top of fuel tank.
Ignition Failure Sensor	At top rear of engine. See <b>Fig. 6</b> .
Input Sensor	At top of transaxle. See <b>Fig. 6</b> .
Knock Sensor	At top rear of engine. See <b>Fig. 6</b> .
MAP Sensor	On intake manifold. See <b>Fig. 6</b> .
Output Sensor	At top of transaxle. See <b>Fig. 6</b> .
O2 Sensor (Front Left)	On left rear side of engine. See <b>Fig. 6</b> .
O2 Sensor (Front Right)	On right rear side of engine. See <b>Fig. 6</b> .
O2 Sensor (Rear Left)	On left rear side of engine. See <b>Fig. 6</b> .
O2 Sensor (Rear Right)	On right front side of engine. See <b>Fig. 6</b> .
Rain Sensor	At center front of roof.
Speed Sensor	On top of transaxle. See <b>Fig. 6</b> .
Tank Pressure Sensor	Near top of fuel tank.
Thermistor	Behind center of dash, on HVAC unit. See <b>Fig. 5</b> .
Throttle Position Sensor	On throttle body. See <b>Fig. 6</b> .
Wheel Speed Sensor (Front) (Left/Right)	On respective front steering knuckle.
Wheel Speed Sensor (Rear) (Left/Right)	On respective rear brake backing plate.

## SOLENOID & SOLENOID VALVES

### SOLENOID & SOLENOID VALVES LOCATION

Component	Component Location
A/T Solenoid Valve	On transaxle housing.
Idle Speed Actuator (ISA)	On throttle body. See <b>Fig. 6</b> .
Purge Solenoid Valve	At top rear of engine. See <b>Fig. 6</b> .
Purge Vent Solenoid	Under right rear of vehicle.

## SWITCHES

### SWITCHES LOCATION

Component	Component Location
A/T Change Lever	Behind lower center of dash. See <b>Fig. 4</b> .
Back Door Switch	At lower center of back door.
Driver Seat Belt Switch	In driver's seat belt buckle.
Inhibitor Switch	At top of transaxle. See <b>Fig. 6</b> .
Oil Pressure Switch	At front of engine. See <b>Fig. 6</b> .
Parking Brake Switch	At base of parking brake lever. See <b>Fig. 5</b> .
Passenger Seat Belt Switch	In passenger's seat belt buckle.
Power Steering Switch	At right front of engine. See <b>Fig. 3</b> .
Stoplight Switch	Above brake pedal, on bracket. See <b>Fig. 5</b> .
Triple Pressure Switch	On top of A/C receiver-drier assembly. See <b>Fig. 3</b> .

# MISCELLANEOUS

## MISCELLANEOUS LOCATION

Component	Component Location
Check Connector	Behind left side of dash. See <b>Fig. 5</b> .
Condenser	At top left of engine. See <b>Fig. 6</b> .
Diagnosis Connector	At left side of engine compartment. See <b>Fig. 3</b> .
Resistor (Front)	Behind right side of dash, on bottom of blower unit. See <b>Fig. 5</b> .
Resistor (Rear)	At right rear of vehicle. See <b>Fig. 2</b> .

# CONNECTORS

## CONNECTORS LOCATION

Component	Component Location
X02 (21 Pin)	At left side of engine compartment, near battery. See <b>Fig. 3</b> .
X03 (21 Pin)	At left side of engine compartment, near battery. See <b>Fig. 3</b> .
X04 (14 Pin)	Behind left side of dash. See <b>Fig. 4</b> .
X05 (20 Pin)	Behind left side of dash. See <b>Fig. 4</b> .
X06 (24 Pin)	Behind left side of dash. See <b>Fig. 4</b> .
X07 (24 Pin)	Behind left side of dash. See <b>Fig. 4</b> .
X08 (20 Pin)	Behind right front of center console. See <b>Fig. 4</b> .
X09 (20 Pin)	Under steering column. See <b>Fig. 5</b> .
X10 (6 Pin)	Under center console.
X11 (24 Pin)	Behind left side of dash, near steering column.
X12 (24 Pin)	Behind left side of dash. See <b>Fig. 5</b> .
X13 (16 Pin)	Behind left side of dash. See <b>Fig. 5</b> .
X14 (20 Pin)	At left side of engine compartment, near brake master cylinder. See <b>Fig. 3</b> .
X15 (30 Pin)	Behind left end of dash. See <b>Fig. 5</b> .
X16 (30 Pin)	Behind right end of dash. See <b>Fig. 5</b> .
X17 (8 Pin)	Behind left taillight assembly.
X18 (6 Pin)	Behind left taillight assembly. See <b>Fig. 2</b> .
X19 (4 Pin)	At top left side of tailgate. See <b>Fig. 2</b> .
X20 (6 Pin)	At top left side of tailgate. See <b>Fig. 2</b> .
X21 (20 Pin)	At left side of roof panel, near "B" pillar.
X22 (16 Pin)	At right rear of engine compartment. See <b>Fig. 3</b> .
X23 (16 Pin)	At right rear of engine compartment. See <b>Fig. 3</b> .
X24 (4 Pin)	At top of engine. See <b>Fig. 3</b> .
X25 (6 Pin)	At top rear of cylinder head. See <b>Fig. 3</b> .

# GROUND

## GROUND'S LOCATION

Component	Component Location
G1	Behind right headlight. See <b>Fig. 3</b> .
G2	Behind right headlight. See <b>Fig. 3</b> .
G3	Behind left headlight. See <b>Fig. 3</b> .
G4	Behind left headlight. See <b>Fig. 3</b> .
G5	At left side of engine compartment, near battery. See <b>Fig. 3</b> .
G6	At left side of engine compartment, under battery. See <b>Fig. 3</b> .
G7	At left side of engine compartment, under battery. See <b>Fig. 3</b> .
G9	Under center console.
G10	Behind left end of dash. See <b>Fig. 5</b> .
G11	Behind left end of dash. See <b>Fig. 5</b> .
G12	Behind right end of dash. See <b>Fig. 5</b> .
G13	Behind right end of dash. See <b>Fig. 5</b> .
G14	Behind left side of dash. See <b>Fig. 5</b> .
G15	Under steering column. See <b>Fig. 5</b> .
G16	Behind left side of dash, right of steering column. See <b>Fig. 5</b> .
G17	Behind left side of dash, right of steering column. See <b>Fig. 5</b> .
G18	Behind right taillight assembly. See <b>Fig. 2</b> .
G19	Behind right taillight assembly. See <b>Fig. 2</b> .
G20	Behind left taillight assembly.
G21	Behind left taillight assembly.
G22	At left side of engine compartment, near battery. See <b>Fig. 3</b> .
G23	At rear of cylinder head. See <b>Fig. 3</b> .
G24	At middle of tailgate. See <b>Fig. 2</b> .
G25	At middle of tailgate. See <b>Fig. 2</b> .
G26	Behind left side of dash, right of steering column. See <b>Fig. 5</b> .
G27	Behind left side of dash, right of steering column. See <b>Fig. 5</b> .
G28	Behind left side of dash, right of steering column. See <b>Fig. 5</b> .

## COMPONENT LOCATION GRAPHICS

**NOTE:** Figures may show multiple component locations. Refer to appropriate table for proper figure references.

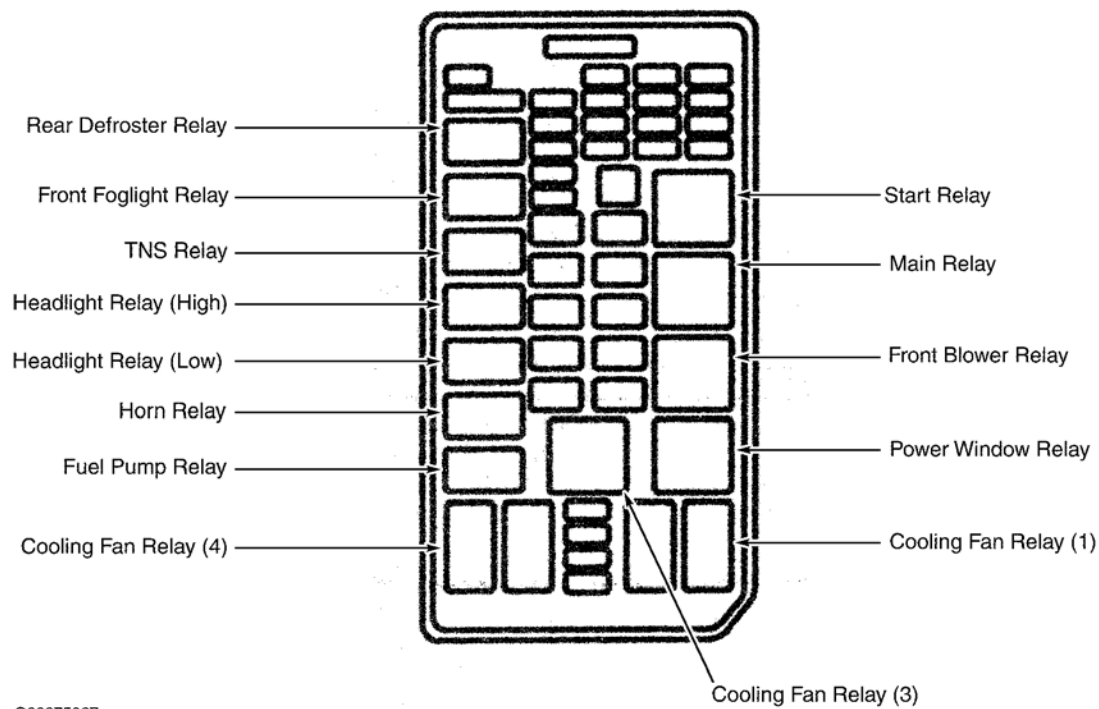

G00075067

**Fig. 1: Engine Compartment Fuse/Relay Box**  
**Courtesy of KIA MOTORS AMERICA, INC.**

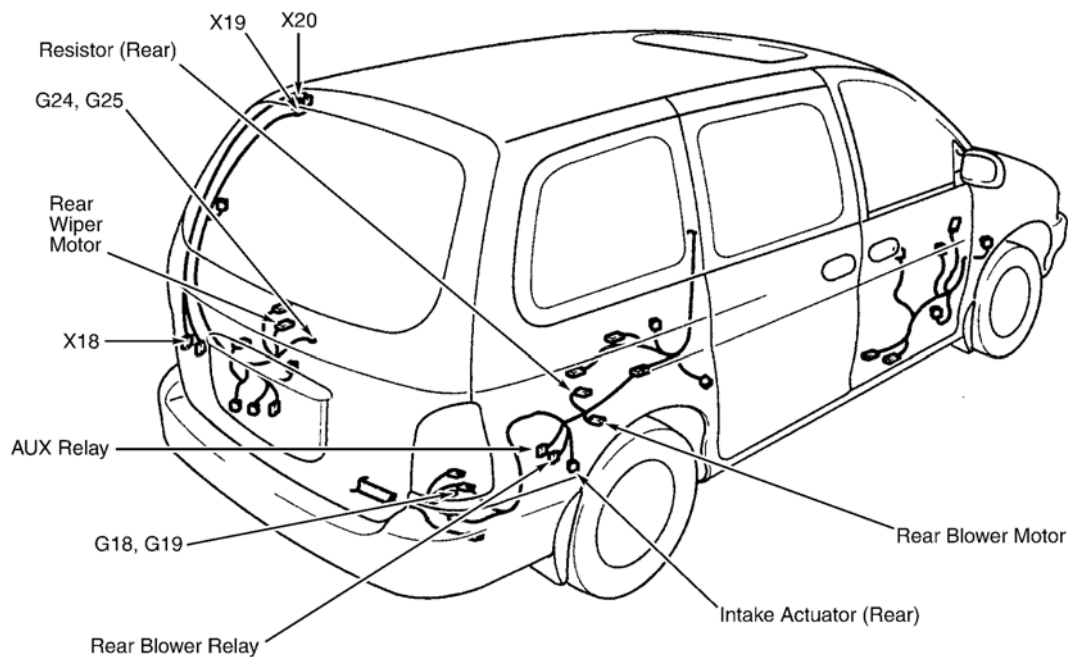

G00074639

**Fig. 2: Right Rear Of Vehicle**  
**Courtesy of KIA MOTORS AMERICA, INC.**

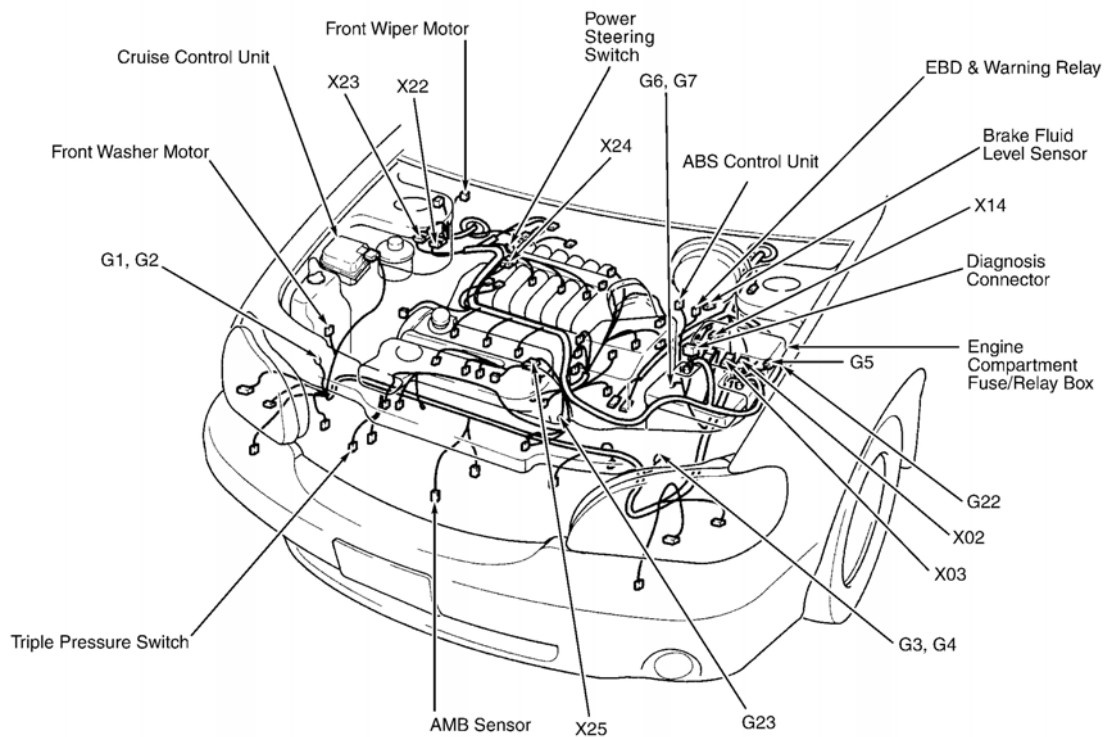

G00074640

**Fig. 3: Engine Compartment**  
Courtesy of KIA MOTORS AMERICA, INC.

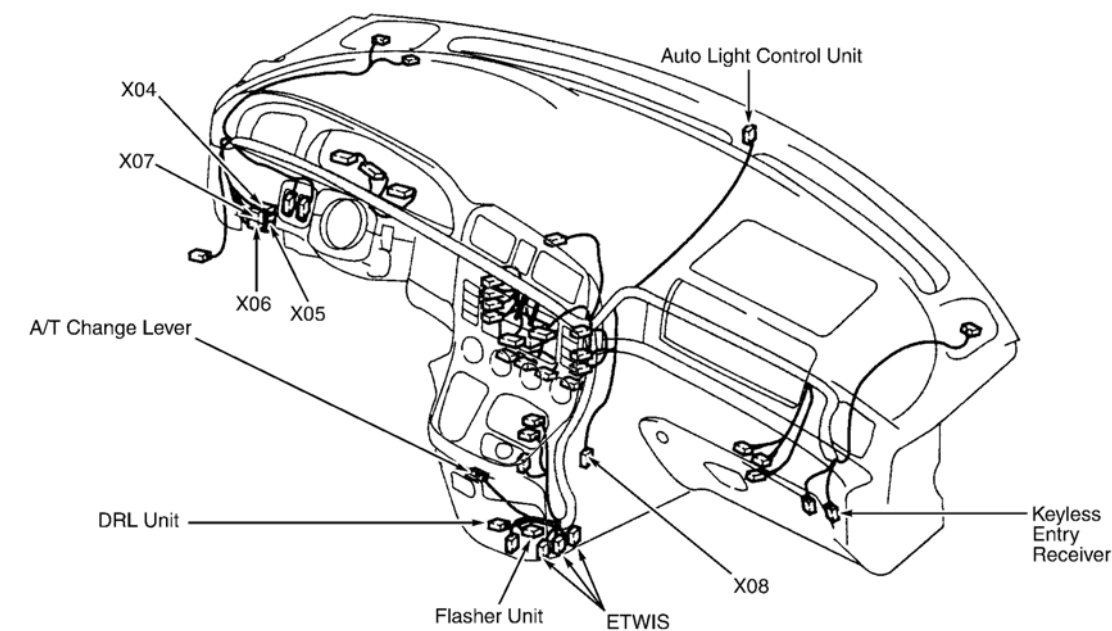

G00074641

**Fig. 4: Dash**  
Courtesy of KIA MOTORS AMERICA, INC.



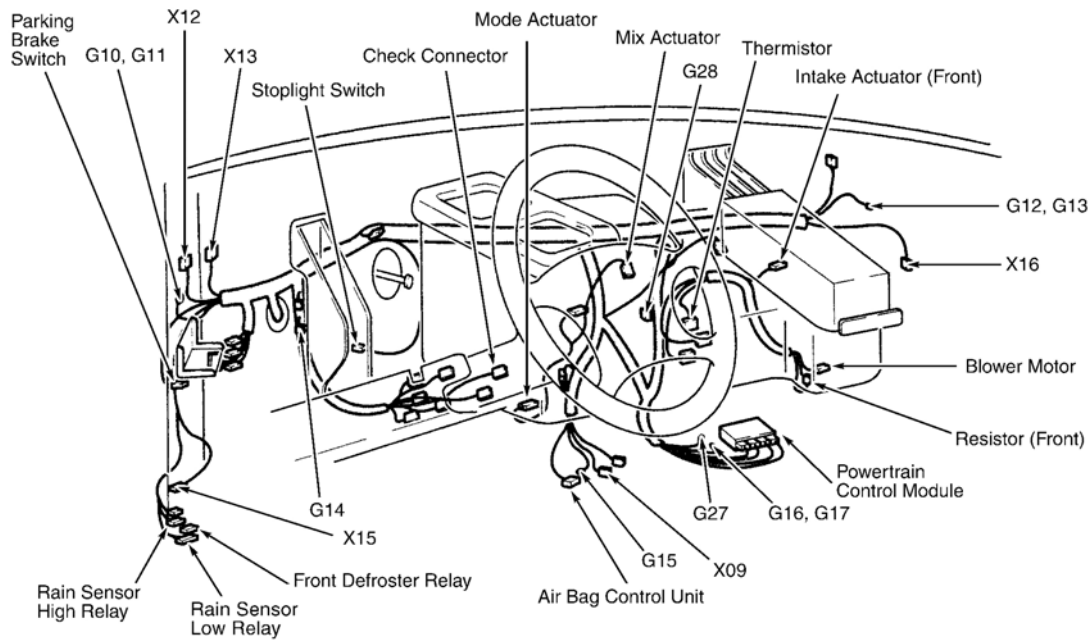

G00074643

**Fig. 5: Left Side Of Dash**  
**Courtesy of KIA MOTORS AMERICA, INC.**

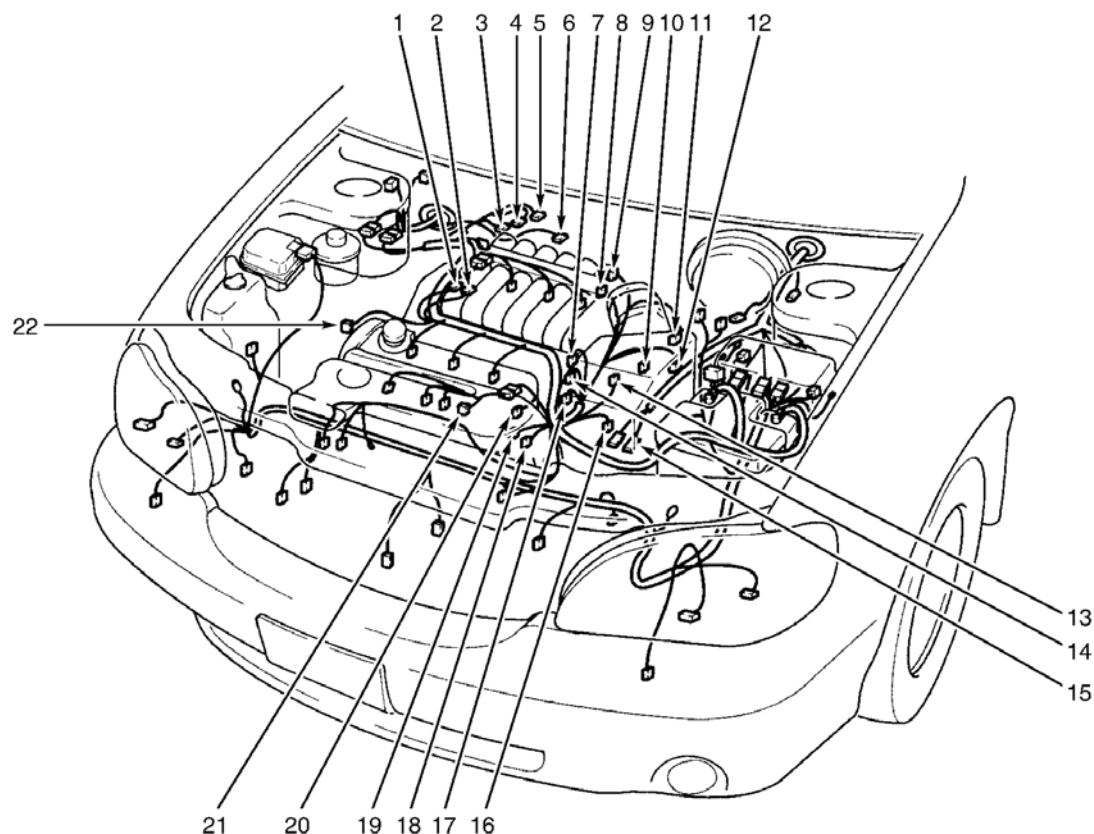

- |                                    |                                       |
|------------------------------------|---------------------------------------|
| 1. Camshaft Position Sensor        | 12. Output Sensor                     |
| 2. Crankshaft Position Sensor      | 13. Airflow Meter                     |
| 3. Variable Intake Control Motor 1 | 14. Engine Coolant Temperature Sensor |
| 4. Variable Intake Control Motor 2 | 15. Inhibitor Switch                  |
| 5. MAP Sensor                      | 16. Input Sensor                      |
| 6. O2 Sensor (Rear Right)          | 17. Ignition Failure Sensor           |
| 7. Purge Solenoid Valve            | 18. O2 Sensor (Front Left)            |
| 8. Idle Speed Actuator (ISA)       | 19. O2 Sensor (Rear Left)             |
| 9. Throttle Position Sensor        | 20. Knock Sensor                      |
| 10. Speed Sensor                   | 21. Condenser                         |
| 11. O2 Sensor (Front Right)        | 22. Oil Pressure Switch               |

G00075072

**Fig. 6: Engine Compartment**  
**Courtesy of KIA MOTORS AMERICA, INC.**